

1. Applications and Features

Purpose	Absorbing pump vibration
Location	Suction and delivery for pump, water receiving tank, cooling tower, chilling unit, etc.
Features	The main body is made of elastic rubber material, which provides excellent vibration absorption. It also can absorb lateral movement, angular deflection, and expansion/contraction even with short product length. Loose flange type.

2. Structure and Parts

Figure 1 shows the structure, and Table 1 shows the part names and materials.

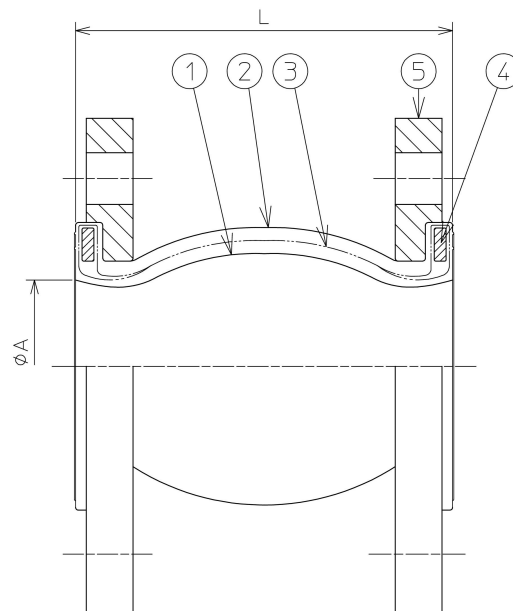

Figure 1 . Structure

Table1. Parts List

No.	Name	Material (Option)
1	Inner layer rubber	Synthetic rubber
2	Outer layer rubber	Synthetic rubber
3	Reinforcement fiber	Nylon cord
4	Solid ring	Carbon steel
5	Flange	Carbon steel (Stainless steel)

※Flange rating : JIS 10K

※Product size : 20A~300A

※When the flange material is SS400, the surface treatment is hot dip galvanizing.

3. Dimensions and maximum working pressure

Table 2 shows dimensions and maximum working pressure.

Table2. Dimensions and maximum working pressure Unit : mm

Size	L	ϕ A	Max. working pressure (MPa)
20A	96	22	1.0
25A	96	25	1.0
32A	96	32	1.0
40A	96	38	1.0
50A	106	50	1.0
65A	107	64	1.0
80A	126	75	1.0
100A	126	99	1.0
125A	157	125	1.0
150A	158	150	1.0
200A	210	200	1.0
250A	210	250	1.0
300A	217	300	1.0

※Maximum working pressure is at normal temperature.

4. Allowable operating movement

Table 3 shows allowable operating movement.

Table3. allowable operating movement

Size	Allowable operating movement				Weight (kg)
	Compression (mm)	Elongation (mm)	Lateral movement (mm)	Angular defection (°)	
20A	8	4	8	6	1.4
25A	8	4	8	6	2.2
32A	8	4	8	6	2.8
40A	8	4	8	6	3.0
50A	8	5	8	6	3.8
65A	12	6	10	6	5.0
80A	12	6	10	6	5.2
100A	18	10	12	6	6.4
125A	18	10	12	8	10.0
150A	18	10	12	8	13.0
200A	25	14	22	8	16.8
250A	25	14	22	8	25.2
300A	25	14	22	8	27.0

※Displacements are individual maximum permissible amounts and are not guaranteed for loads acting simultaneously.

5. Applicable temperature range

-20℃～70℃

6. Mounting bolt length and bolt tightening torque (recommended value)

Table 4 shows the length of the mounting bolt.

Table 5 shows the tightening torque of the bolt.

Table 4. Mounting bolt length (JIS10K)

Size	Mounting bolt length		
	Bolt size	Length (Below Neck)	Quantity
20A	M12	50	8
25A	M16	50	8
32A	M16	50	8
40A	M16	50	8
50A	M16	60	8
65A	M16	60	8
80A	M16	65	16
100A	M16	65	16
125A	M20	75	16
150A	M20	75	16
200A	M20	75	24
250A	M22	90	24
300A	M22	90	32

Table 5. Torque of the bolt

Size	Torque (N·m)
20A	25
25A～100A	30
125A～200A	40
250A～300A	45

※Mounting bolt length does not include the
thickness of flat washers and spring washers.

7. Inspection

Inspection items : Visual inspection, Dimensional inspection (overall length),
pressure resistance inspection

Frequency : Visual inspection are all products.

Dimensional and pressure resistance inspections are sampling inspections.

8. Notes

- Cannot be used for hot water supply. Please use A • V • JOINT、ZTF-5000、ZRJ-BT.
- Cannot be used for swimming pool circulating water.
Please use ZTF-5000 or ZRJ-BT.
- Cannot be used for special liquids (chemicals, etc.).
Please use ZTF-5000 and ZRJ-BT.
- In environments exposed to high concentrations of ozone, cracks may occur on the surface due to ozone degradation.
In such cases, we recommend choosing stainless steel products instead of rubber products.
- Insert mounting bolt from product side and tighten bolts evenly in diagonal line order.
- The service life of rubber fittings may be reduced depending on the conditions of use.
For details, please refer to the precautions in the catalog.
- Please refer to the "Installation Instructions" for installation procedures.